



# Burwood East

**CITY OF WHITEHORSE- STATEMENT OF TREE SIGNIFICANCE**

Property Address: 11 Bettina St Burwood East  
 Melways Ref: 61-J7  
 Survey Dates: 10.5.02 / March – April 2004

Tree No.	1	2	3
<b>Tree Name</b>	Eucalyptus cephalocarpa Silver Leaf Stringybark		
<b>Tree Size</b>	Mature		
<b>Height</b>	18m		
<b>Spread</b>	10m		
<b>Significance*</b>	L		
<b>Age (years)</b>	30-60		
<b>Condition*</b>	G		
<b>Notes</b>	Location- Frontage, South This tree is a good quality specimen		

\* Significance: N-National, S-State, R-Regional, L- Local  
 \* Condition: E- Excellent, G-Good, F-Fair, P-Poor, D-Dead

**Criteria for Significance (please refer page x):**

Historical significance	Rare/Localised distribution	Horticultural/Genetic Value	Particularly old
Curious growth form	Outstanding size	Outstanding Example of the Species	✓ Unique environmental contribution
Unique Location/Context	Aesthetic Value	Aboriginal Culture	

**Statement of Significance:**

This is an indigenous habitat tree of local provenance, that is part of regional vegetation linkages. It provides a vegetation corridor for local bird-life and fauna. It acts as a vegetation source upon which re-vegetation and regeneration of indigenous flora can occur. This tree is integral to the establishment of a sustainable urban and native landscape.

**Map:**

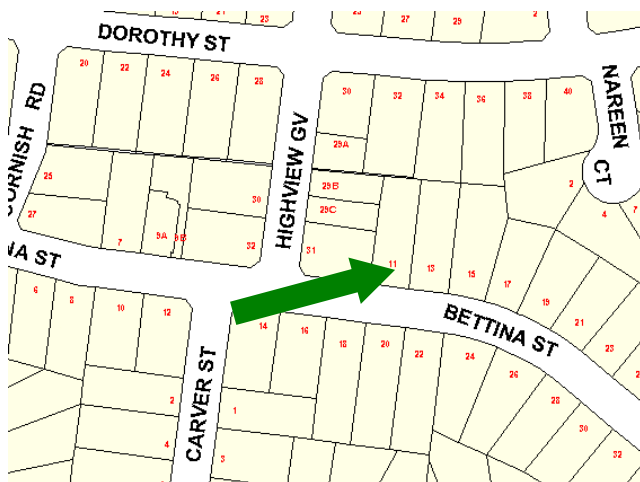

**Photo(s):**



**CITY OF WHITEHORSE- STATEMENT OF TREE SIGNIFICANCE**

**Property Address:** 17 Bettina St Burwood East  
 Melways Ref: 61-J7  
 Survey Dates: 18.1.02 / March – April 2004

Tree No.	1	2	3
<b>Tree Name</b>	Angophora costata Apple Gum		
<b>Tree Size</b>	Mature		
<b>Height</b>	18m		
<b>Spread</b>	13m		
<b>Significance*</b>	R		
<b>Age (years)</b>	30-60		
<b>Condition*</b>	G		
<b>Notes</b>	Location- Frontage  This tree is a good quality specimen		

\* Significance: N-National, S-State, R-Regional, L- Local  
 \* Condition: E- Excellent, G-Good, F-Fair, P-Poor, D-Dead

**Criteria for Significance (please refer page x):**

Historical significance		Rare/Localised distribution		Horticultural/Genetic Value		Particularly old
Curious growth form		Outstanding size		Outstanding Example of the Species		Unique environmental contribution
Unique Location/Context	✓	Aesthetic Value		Aboriginal Culture		

**Statement of Significance:**

The age and size of this tree provides an important contribution to the immediate landscape.

**Map:**

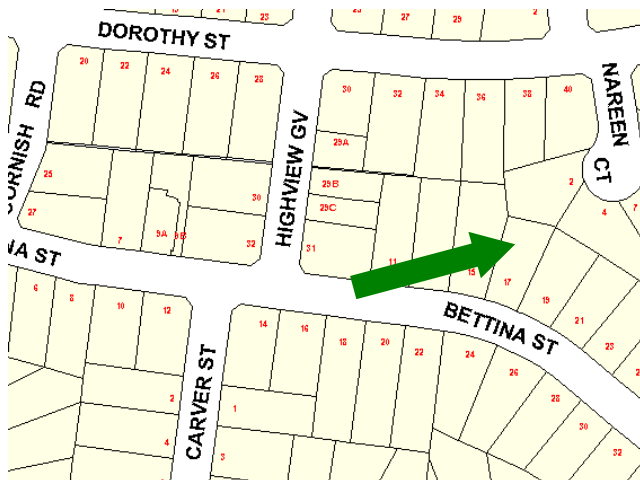

**Photo(s):**



**CITY OF WHITEHORSE- STATEMENT OF TREE SIGNIFICANCE**

**Property Address:** 18 Bettina St Burwood East  
 Melways Ref: 61-J7  
 Survey Dates: 16.1.02 / March – April 2004

Tree No.	1	2	3
<b>Tree Name</b>	Eucalyptus mannifera Brittle Gum		
<b>Tree Size</b>	Mature		
<b>Height</b>	18m		
<b>Spread</b>	8m		
<b>Significance*</b>	R		
<b>Age (years)</b>	30-60		
<b>Condition*</b>	G		
<b>Notes</b>	Location- Frontage  This tree is a good quality specimen		

\* Significance: N-National, S-State, R-Regional, L- Local  
 \* Condition: E- Excellent, G-Good, F-Fair, P-Poor, D-Dead

**Criteria for Significance (please refer page x):**

Historical significance		Rare/Localised distribution	Horticultural/Genetic Value	Particularly old
Curious growth form		Outstanding size	Outstanding Example of the Species	Unique environmental contribution
Unique Location/Context	✓	Aesthetic Value	Aboriginal Culture	

**Statement of Significance:**

The age and size of this tree provides an important contribution to the immediate landscape

**Map:**

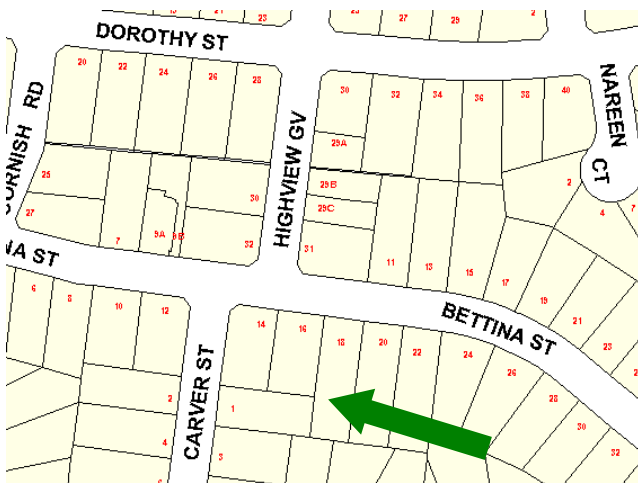

**Photo(s):**

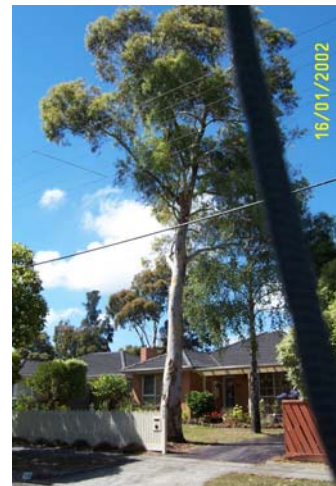

**CITY OF WHITEHORSE- STATEMENT OF TREE SIGNIFICANCE**

**Property Address:** 329 Blackburn Rd St Burwood East  
**Melways Ref:** 62-A1  
**Survey Dates:** 26.4.02 / March – April 2004

Tree No.	1	2	3
<b>Tree Name</b>	Corymbia maculata Spotted Gum	Corymbia maculata Spotted Gum	
<b>Tree Size</b>	Mature	Mature	
<b>Height</b>	24m	19m	
<b>Spread</b>	15m	11m	
<b>Significance*</b>	L	L	
<b>Age (years)</b>	30-60	30-60	
<b>Condition*</b>	G	G	
<b>Notes</b>	Location- Frontage This tree is a good quality specimen	Location- Frontage This tree is a good quality specimen	

\* Significance: N-National, S-State, R-Regional, L- Local  
 \* Condition: E- Excellent, G-Good, F-Fair, P-Poor, D-Dead

**Criteria for Significance (please refer page x):**

Historical significance		Rare/Localised distribution		Horticultural/Genetic Value		Particularly old
Curious growth form		Outstanding size		Outstanding Example of the Species		Unique environmental contribution
Unique Location/Context	✓	Aesthetic Value		Aboriginal Culture		

**Statement of Significance:**

The age and size of this tree provides an important contribution to the immediate landscape.

**Map:**

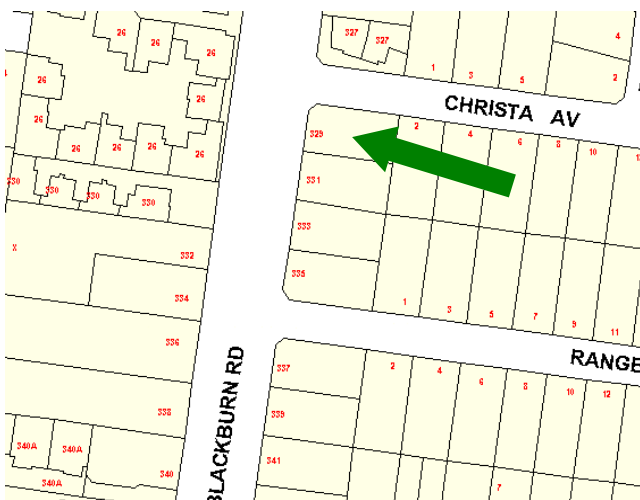

**Photo(s):**



**CITY OF WHITEHORSE- STATEMENT OF TREE SIGNIFICANCE**

**Property Address:** 340 Blackburn Rd St Burwood East  
 Melways Ref: 62-A1  
 Survey Dates: 25.4.02 / March – April 2004

Tree No.	1	2	3
<b>Tree Name</b>	Quercus palustris Pin Oak		
<b>Tree Size</b>	Mature		
<b>Height</b>	20m		
<b>Spread</b>	20m		
<b>Significance*</b>	R		
<b>Age (years)</b>	30-60		
<b>Condition*</b>	G		
<b>Notes</b>	Location- Frontage This tree is a good quality specimen		

\* Significance: N-National, S-State, R-Regional, L- Local  
 \* Condition: E- Excellent, G-Good, F-Fair, P-Poor, D-Dead

**Criteria for Significance (please refer page x):**

Historical significance		Rare/Localised distribution		Horticultural/Genetic Value		Particularly old
Curious growth form		Outstanding size		Outstanding Example of the Species		Unique environmental contribution
Unique Location/Context	✓	Aesthetic Value		Aboriginal Culture		

**Statement of Significance:**

The age and size of this tree provides an important contribution to the immediate landscape.

**Map:**

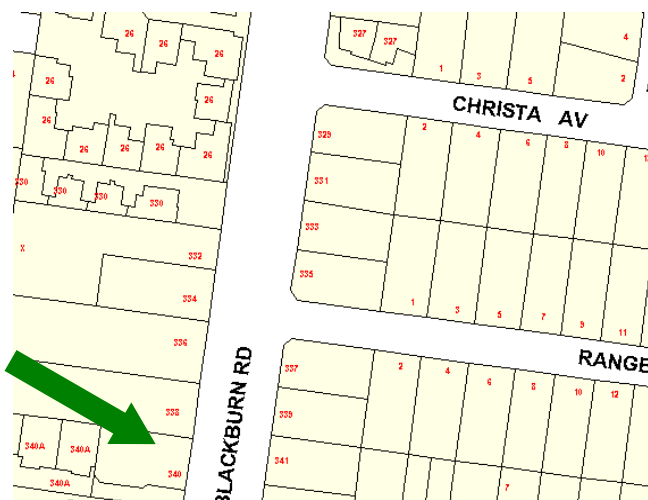

**Photo(s):**



**CITY OF WHITEHORSE- STATEMENT OF TREE SIGNIFICANCE**

**Property Address:** 12 Cam St Burwood East  
**Melways Ref:** 61-G7  
**Survey Dates:** 13.3.02 / March – April 2004

Tree No.	1	2	3
<b>Tree Name</b>	Eucalyptus obliqua Messmate Stringybark		
<b>Tree Size</b>	Mature		
<b>Height</b>	18m		
<b>Spread</b>	8m		
<b>Significance*</b>	L		
<b>Age (years)</b>	30-60		
<b>Condition*</b>	G		
<b>Notes</b>	Location- Frontage, west side boundary  This tree is generally a good quality specimen, however some form deficiencies are evident with space competition from trees in Lawrence Reserve.		

\* Significance: N-National, S-State, R-Regional, L- Local  
 \* Condition: E- Excellent, G-Good, F-Fair, P-Poor, D-Dead

**Criteria for Significance (please refer page x):**

Historical significance	Rare/Localised distribution	Horticultural/Genetic Value	Particularly old
Curious growth form	Outstanding size	Outstanding Example of the Species	
Unique Location/Context	✓ Aesthetic Value	Aboriginal Culture	

**Statement of Significance:**

The age and size of this tree provides an important contribution to the immediate landscape.

**Map:**



**Photo(s):**



**CITY OF WHITEHORSE- STATEMENT OF TREE SIGNIFICANCE**

**Property Address:** 17 Carver St Burwood East  
 Melways Ref: 61-G7  
 Survey Dates: 18.3.02 / March – April 2004

Tree No.	1	2	3
<b>Tree Name</b>	Eucalyptus leucoxylon Blue Gum		
<b>Tree Size</b>	Mature		
<b>Height</b>	18m		
<b>Spread</b>	16m		
<b>Significance*</b>	L		
<b>Age (years)</b>	30-60		
<b>Condition*</b>	P-F		
<b>Notes</b>	This tree is in a declining condition		

\* Significance: N-National, S-State, R-Regional, L- Local  
 \* Condition: E- Excellent, G-Good, F-Fair, P-Poor, D-Dead

**Criteria for Significance (please refer page x):**

Historical significance		Rare/Localised distribution		Horticultural/Genetic Value		Particularly old
Curious growth form		Outstanding size		Outstanding Example of the Species		Unique environmental contribution
Unique Location/Context	✓	Aesthetic Value		Aboriginal Culture		

**Statement of Significance:**

The age and size of this tree provides an important contribution to the immediate landscape.

**Map:**

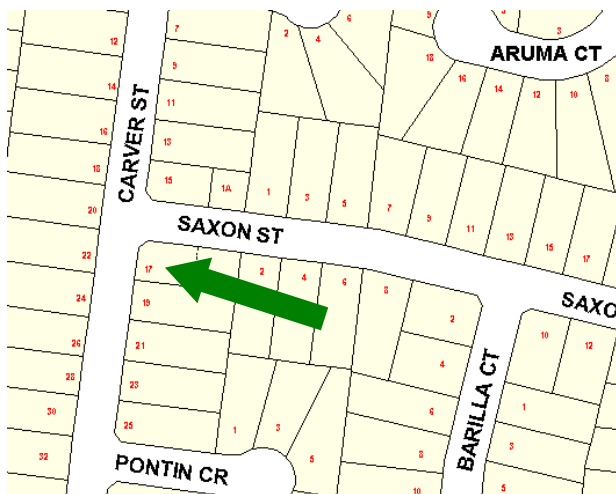

**Photo(s):**





**CITY OF WHITEHORSE- STATEMENT OF TREE SIGNIFICANCE**

This page is intentionally blank  
Statement of Tree Significance deleted by Amendment C 83

**CITY OF WHITEHORSE- STATEMENT OF TREE SIGNIFICANCE**

**Property Address:** 36 Dorothy St Burwood East  
 Melways Ref: 61-H7  
 Survey Dates: 18.3.02 / March – April 2004

Tree No.	1	2	3
<b>Tree Name</b>	Eucalyptus viminalis Manna Gum		
<b>Tree Size</b>	Mature		
<b>Height</b>	21m		
<b>Spread</b>	16m		
<b>Significance*</b>	L		
<b>Age (years)</b>	30-60		
<b>Condition*</b>	G		
<b>Notes</b>	Location- Rear, south  This tree is a good quality specimen.		

\* Significance: N-National, S-State, R-Regional, L- Local  
 \* Condition: E- Excellent, G-Good, F-Fair, P-Poor, D-Dead

**Criteria for Significance (please refer page x):**

Historical significance		Rare/Localised distribution		Horticultural/Genetic Value		Particularly old
Curious growth form		Outstanding size		Outstanding Example of the Species		Unique environmental contribution
Unique Location/Context	✓	Aesthetic Value		Aboriginal Culture		

**Statement of Significance:**

The age and size of this tree provides an important contribution to the immediate landscape.

**Map:**

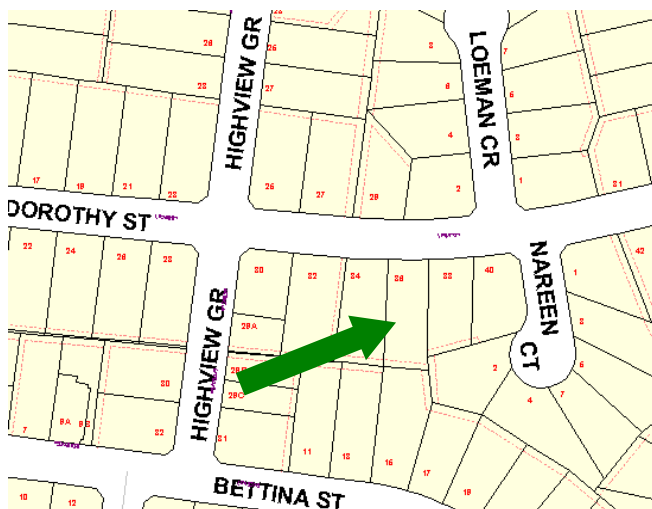

**Photo(s):**



**CITY OF WHITEHORSE- STATEMENT OF TREE SIGNIFICANCE**

**Property Address:** 23 Gareth Dr Burwood East  
**Melways Ref:** 61-J8  
**Survey Dates:** 16.1.02 / March – April 2004

Tree No.	1	2	3
<b>Tree Name</b>	Eucalyptus cephalocarpa Silver Leaf Stringybark	Eucalyptus cephalocarpa Silver Leaf Stringybark	
<b>Tree Size</b>	Mature	Mature	
<b>Height</b>	21m	21m	
<b>Spread</b>	12m	7m	
<b>Significance*</b>	L	L	
<b>Age (years)</b>	60-100	60-100	
<b>Condition*</b>	G	G	
<b>Notes</b>	Location- Frontage, west  This tree is a good quality specimen	Location- Frontage, west  This tree is a good quality specimen	

\* Significance: N-National, S-State, R-Regional, L- Local  
 \* Condition: E- Excellent, G-Good, F-Fair, P-Poor, D-Dead

**Criteria for Significance (please refer page x):**

Historical significance	Rare/Localised distribution	Horticultural/Genetic Value		Particularly old
Curious growth form	Outstanding size	Outstanding Example of the Species	✓	Unique environmental contribution
Unique Location/Context	Aesthetic Value	Aboriginal Culture		

**Statement of Significance:**

These are indigenous habitat trees of local provenance, that are part of regional vegetation linkages. They provide a vegetation corridor for local bird life and fauna. They act as a vegetation source upon which re-vegetation and re-generation of indigenous flora can occur. These trees are integral to the establishment of a sustainable urban and native landscape.

**Map:**

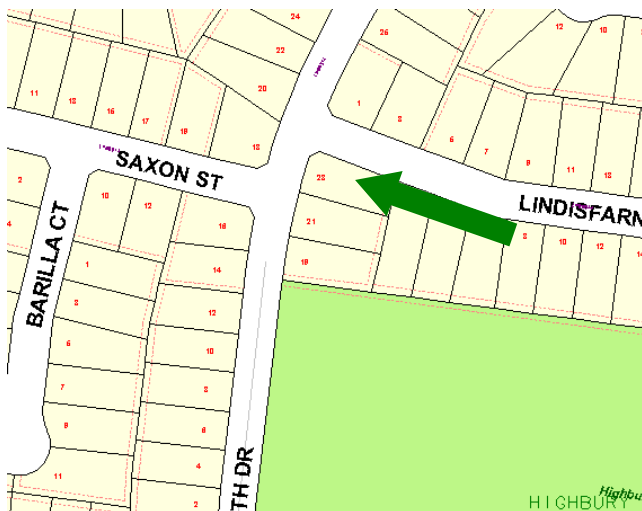

**Photo(s):**



**CITY OF WHITEHORSE- STATEMENT OF TREE SIGNIFICANCE**

**Property Address:** 31 Highview Grove Burwood East  
 Melways Ref: 61-J7  
 Survey Dates: 16.1.02 / March – April 2004

Tree No.	1	2	3
<b>Tree Name</b>	Eucalyptus botryiodes Mahogany Gum		
<b>Tree Size</b>	Mature		
<b>Height</b>	18m		
<b>Spread</b>	8m		
<b>Significance*</b>	R		
<b>Age (years)</b>	30-60		
<b>Condition*</b>	G		
<b>Notes</b>	This tree is a good quality specimen		

\* Significance: N-National, S-State, R-Regional, L- Local  
 \* Condition: E- Excellent, G-Good, F-Fair, P-Poor, D-Dead

**Criteria for Significance (please refer page x):**

	Historical significance	Rare/Localised distribution	Horticultural/Genetic Value	Particularly old
	Curious growth form	Outstanding size	Outstanding Example of the Species	Unique environmental contribution
✓	Unique Location/Context	Aesthetic Value	Aboriginal Culture	

**Statement of Significance:**

This is an indigenous habitat tree of local provenance, that is part of regional vegetation linkages. It provides a vegetation corridor for local bird-life and fauna. It acts as a vegetation source upon which re-vegetation and regeneration of indigenous flora can occur. This tree is integral to the establishment of a sustainable urban and native landscape.

**Map:**

**Photo(s):**

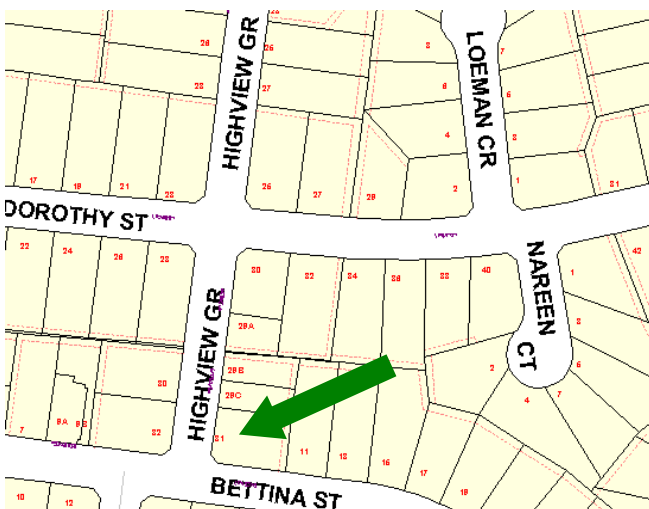

**CITY OF WHITEHORSE- STATEMENT OF TREE SIGNIFICANCE**

**Property Address:** 206 Holland Rd Burwood East  
**Melways Ref:** 61-K6  
**Survey Dates:** 29.4.02 / March – April 2004

Tree No.	1	2	3
<b>Tree Name</b>	Quercus palustris Pin Oak		
<b>Tree Size</b>	Mature		
<b>Height</b>	20m		
<b>Spread</b>	12m		
<b>Significance*</b>	R		
<b>Age (years)</b>	30-60		
<b>Condition*</b>	G		
<b>Notes</b>	Location- Rear, SW corner		

\* Significance: N-National, S-State, R-Regional, L- Local  
 \* Condition: E- Excellent, G-Good, F-Fair, P-Poor, D-Dead

**Criteria for Significance (please refer page x):**

Historical significance		Rare/Localised distribution		Horticultural/Genetic Value		Particularly old
Curious growth form		Outstanding size		Outstanding Example of the Species		Unique environmental contribution
Unique Location/Context	✓	Aesthetic Value		Aboriginal Culture		

**Statement of Significance:**

The age and size of this tree provides an important contribution to the immediate landscape.

**Map:**

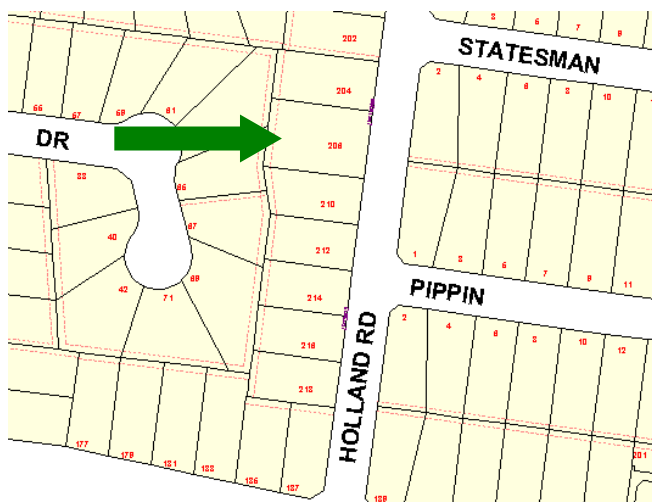

**Photo(s):**



**CITY OF WHITEHORSE- STATEMENT OF TREE SIGNIFICANCE**

**Property Address:** 16 Inala Ct Burwood East  
 Melways Ref: 61-H6  
 Survey Dates: 29.4.02 / March – April 2004

Tree No.	1	2	3
<b>Tree Name</b>	Eucalyptus macrocarpa Mottlecah		
<b>Tree Size</b>	Mature		
<b>Height</b>	21m		
<b>Spread</b>	13m		
<b>Significance*</b>	L		
<b>Age (years)</b>	30-60		
<b>Condition*</b>	G		
<b>Notes</b>	Location- Frontage  This tree is a good quality specimen		

\* Significance: N-National, S-State, R-Regional, L- Local  
 \* Condition: E- Excellent, G-Good, F-Fair, P-Poor, D-Dead

**Criteria for Significance (please refer page x):**

Historical significance		Rare/Localised distribution		Horticultural/Genetic Value		Particularly old
Curious growth form		Outstanding size		Outstanding Example of the Species		Unique environmental contribution
Unique Location/Context	✓	Aesthetic Value		Aboriginal Culture		

**Statement of Significance:**

The age and size of this tree provides an important contribution to the immediate landscape.

**Map:**

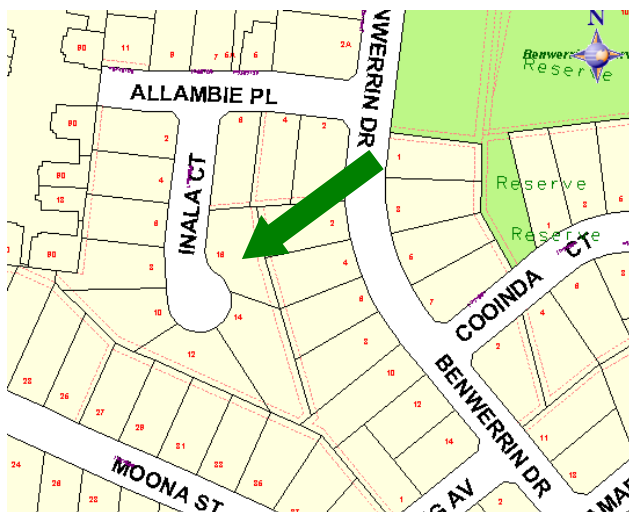

**Photo(s):**



**CITY OF WHITEHORSE- STATEMENT OF TREE SIGNIFICANCE**

**Property Address:** 1 Lindisfarne Dve Burwood East  
 Melways Ref: 61-K8  
 Survey Dates: 31.5.02 / March – April 2004

Tree No.	1	2	3
<b>Tree Name</b>	Eucalyptus cephalocarpa Silver Leaf Stringybark		
<b>Tree Size</b>	Mature		
<b>Height</b>	22m		
<b>Spread</b>	13m		
<b>Significance*</b>	L		
<b>Age (years)</b>	30-60		
<b>Condition*</b>	G		
<b>Notes</b>	Location- SW corner to Gareth Drive  This tree is a good quality specimen		

\* Significance: N-National, S-State, R-Regional, L- Local  
 \* Condition: E- Excellent, G-Good, F-Fair, P-Poor, D-Dead

**Criteria for Significance (please refer page x):**

Historical significance	Rare/Localised distribution	Horticultural/Genetic Value	Particularly old
Curious growth form	Outstanding size	Outstanding Example of the Species	✓ Unique environmental contribution
Unique Location/Context	Aesthetic Value	Aboriginal Culture	

**Statement of Significance:**

This is an indigenous habitat tree of local provenance, that is part of regional vegetation linkages. It provides a vegetation corridor for local bird-life and fauna. It acts as a vegetation source upon which re-vegetation and regeneration of indigenous flora can occur. This tree is integral to the establishment of a sustainable urban and native landscape.

**Map:**

**Photo(s):**

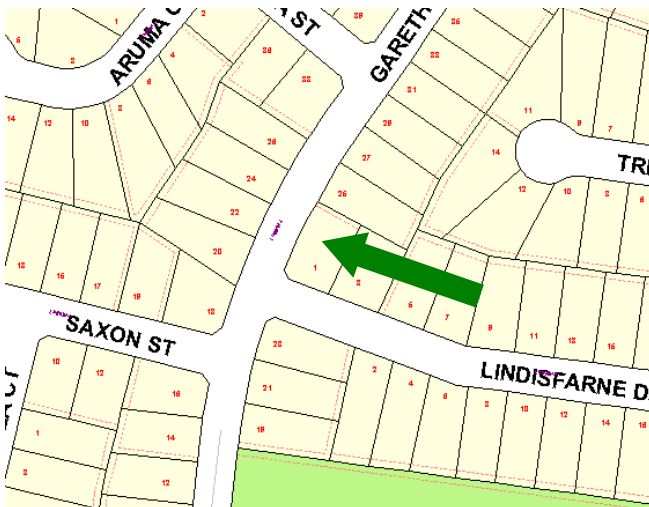

**CITY OF WHITEHORSE- STATEMENT OF TREE SIGNIFICANCE**

**Property Address:** 2 Lindisfarne Dve Burwood East  
 Melways Ref: 61-K8  
 Survey Dates: 31.5.02 / March – April 2004

Tree No.	1	2	3
<b>Tree Name</b>	Eucalyptus cephalocarpa Silver Leaf Stringybark		
<b>Tree Size</b>	Mature		
<b>Height</b>	12m		
<b>Spread</b>	10m		
<b>Significance*</b>	L		
<b>Age (years)</b>	30-60		
<b>Condition*</b>	G		
<b>Notes</b>	Location- Front, west side  This tree is a good quality specimen		

\* Significance: N-National, S-State, R-Regional, L- Local  
 \* Condition: E- Excellent, G-Good, F-Fair, P-Poor, D-Dead

**Criteria for Significance (please refer page x):**

Historical significance	Rare/Localised distribution	Horticultural/Genetic Value	Particularly old
Curious growth form	Outstanding size	Outstanding Example of the Species	✓ Unique environmental contribution
Unique Location/Context	Aesthetic Value	Aboriginal Culture	

**Statement of Significance:**

This is an indigenous habitat tree of local provenance, that is part of regional vegetation linkages. It provides a vegetation corridor for local bird-life and fauna. It acts as a vegetation source upon which re-vegetation and regeneration of indigenous flora can occur. This tree is integral to the establishment of a sustainable urban and native landscape.

**Map:**

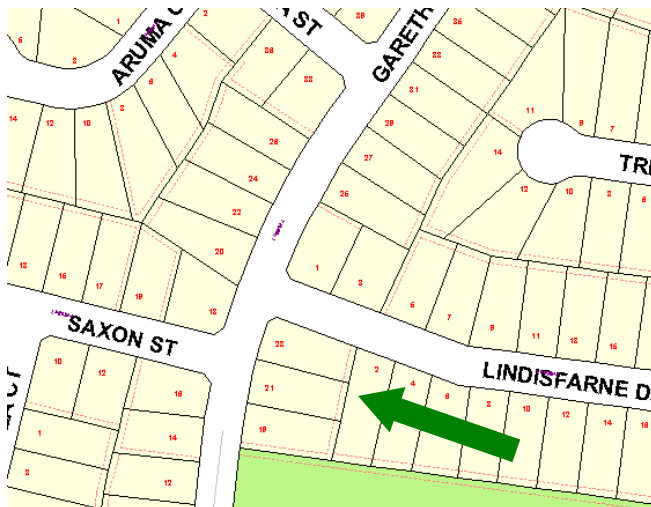

**Photo(s):**





**CITY OF WHITEHORSE- STATEMENT OF TREE SIGNIFICANCE**

**Property Address:** 5 Lindisfarne Dve Burwood East  
 Melways Ref: 61-K8  
 Survey Dates: 31.5.02 / March – April 2004

Tree No.	1	2	3
<b>Tree Name</b>	Eucalyptus cephalocarpa Silver Leaf Stringybark	Eucalyptus cephalocarpa Silver Leaf Stringybark	
<b>Tree Size</b>	Mature	Mature	
<b>Height</b>	16m	18m	
<b>Spread</b>	10m	15m	
<b>Significance*</b>	L	L	
<b>Age (years)</b>	30-60	30-60	
<b>Condition*</b>	G	G	
<b>Notes</b>	Location- Rear (north) This tree is a good quality specimen	Location- Front (south) This tree is a good quality specimen	

\* Significance: N-National, S-State, R-Regional, L- Local  
 \* Condition: E- Excellent, G-Good, F-Fair, P-Poor, D-Dead

**Criteria for Significance (please refer page x):**

Historical significance	Rare/Localised distribution	Horticultural/Genetic Value	Particularly old
Curious growth form	Outstanding size	Outstanding Example of the Species	✓ Unique environmental contribution
Unique Location/Context	Aesthetic Value	Aboriginal Culture	

**Statement of Significance:**

These are indigenous habitat trees of local provenance, that are part of regional vegetation linkages. They provide a vegetation corridor for local bird life and fauna. They act as a vegetation source upon which re-vegetation and re-generation of indigenous flora can occur. These trees are integral to the establishment of a sustainable urban and native landscape.

**Map:**

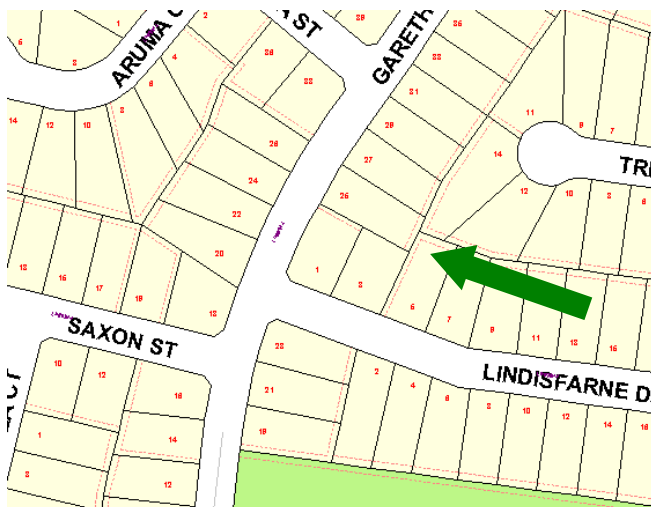

**Photo(s):**



**CITY OF WHITEHORSE- STATEMENT OF TREE SIGNIFICANCE**

**Property Address:** 25 Lorraine Dve Burwood East  
 Melways Ref: 61-H6  
 Survey Dates: 21.1.02 / March – April 2004

Tree No.	1	2	3
<b>Tree Name</b>	Quercus palustris Pin Oak		
<b>Tree Size</b>	Mature		
<b>Height</b>	16m		
<b>Spread</b>	12m		
<b>Significance*</b>	R		
<b>Age (years)</b>	30-60		
<b>Condition*</b>	G		
<b>Notes</b>	Location- Rear, NW  This tree is a good quality specimen.  Owner advises tree is 35 years old and purchased from a fete.		

\* Significance: N-National, S-State, R-Regional, L- Local  
 \* Condition: E- Excellent, G-Good, F-Fair, P-Poor, D-Dead

**Criteria for Significance (please refer page x):**

Historical significance		Rare/Localised distribution		Horticultural/Genetic Value		Particularly old
Curious growth form		Outstanding size		Outstanding Example of the Species		Unique environmental contribution
Unique Location/Context	✓	Aesthetic Value		Aboriginal Culture		

**Statement of Significance:**

The age and size of this tree provides an important contribution to the immediate landscape.

**Map:**

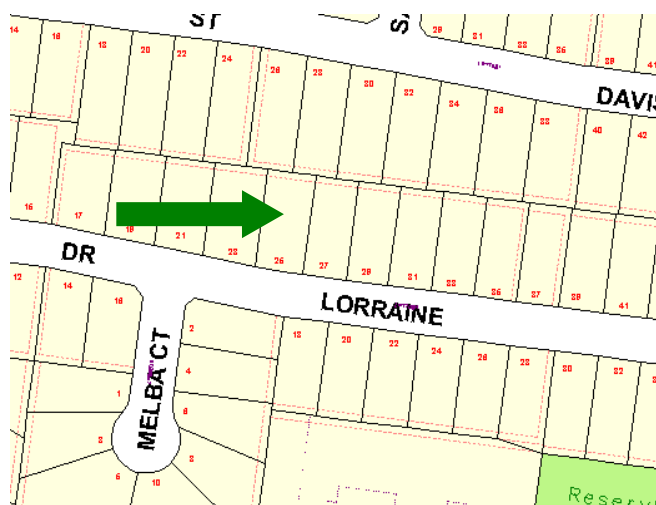

**Photo(s):**



**CITY OF WHITEHORSE- STATEMENT OF TREE SIGNIFICANCE**

**Property Address:** 24 Moona St Burwood East

Melways Ref: 61-G7

Survey Dates: 29.4.02 / March – April 2004

Tree No.	1	2	3
Tree Name	Eucalyptus citriodora Lemon Scented Gum		
Tree Size	Mature		
Height	22m		
Spread	16m		
Significance*	L		
Age (years)	30-60		
Condition*	G		
Notes	Location- frontage, west side  This tree is a good quality specimen		

\* Significance: N-National, S-State, R-Regional, L- Local

\* Condition: E- Excellent, G-Good, F-Fair, P-Poor, D-Dead

**Criteria for Significance (please refer page x):**

Historical significance		Rare/Localised distribution		Horticultural/Genetic Value		Particularly old
Curious growth form		Outstanding size		Outstanding Example of the Species		Unique environmental contribution
Unique Location/Context	✓	Aesthetic Value		Aboriginal Culture		

**Statement of Significance:**

The age and size of this tree provides an important contribution to the immediate landscape.

**Map:**

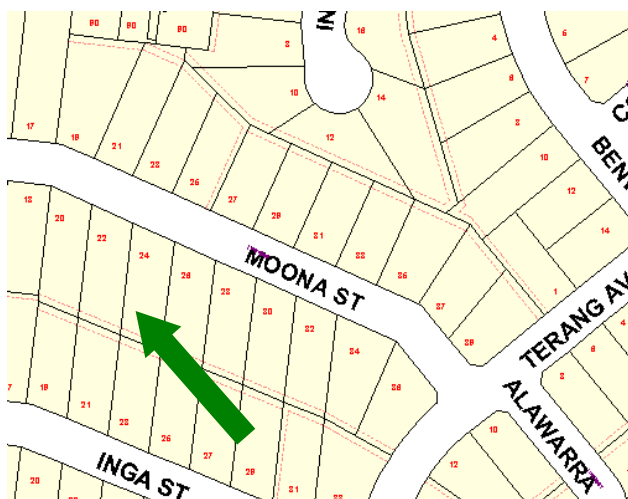

**Photo(s):**



**CITY OF WHITEHORSE- STATEMENT OF TREE SIGNIFICANCE**

**Property Address:** 44 Newhaven Rd Burwood East  
**Melways Ref:** 62-A8  
**Survey Dates:** 1.4.02 / March – April 2004

Tree No.	1	2	3
<b>Tree Name</b>	Eucalyptus cephalocarpa Silver Leaf Stringybark		
<b>Tree Size</b>	Mature		
<b>Height</b>	24m		
<b>Spread</b>	20m		
<b>Significance*</b>	L		
<b>Age (years)</b>	30-60		
<b>Condition*</b>	G		
<b>Notes</b>	Location- Rear, South West  This tree is a good quality specimen		

\* Significance: N-National, S-State, R-Regional, L- Local  
 \* Condition: E- Excellent, G-Good, F-Fair, P-Poor, D-Dead

**Criteria for Significance (please refer page x):**

Historical significance	Rare/Localised distribution	Horticultural/Genetic Value	Particularly old
Curious growth form	Outstanding size	Outstanding Example of the Species	✓ Unique environmental contribution
Unique Location/Context	Aesthetic Value	Aboriginal Culture	

**Statement of Significance:**

This is an indigenous habitat tree of local provenance, that is part of regional vegetation linkages. It provides a vegetation corridor for local bird-life and fauna. It acts as a vegetation source upon which re-vegetation and regeneration of indigenous flora can occur. This tree is integral to the establishment of a sustainable urban and native landscape.

**Map:**

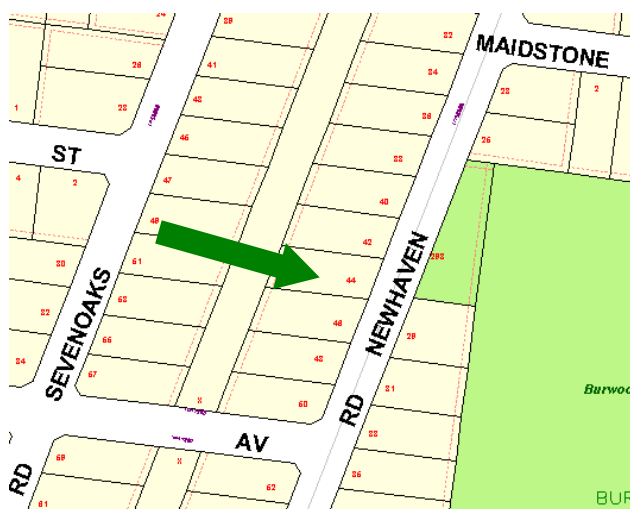

**Photo(s):**



**CITY OF WHITEHORSE- STATEMENT OF TREE SIGNIFICANCE**

**Property Address:** 4 Royton St Burwood East  
 Melways Ref: 61-H5  
 Survey Dates: 26.5.02 / March – April 2004

Tree No.	1	2	3
<b>Tree Name</b>	Quercus robur Common Oak		
<b>Tree Size</b>	Mature		
<b>Height</b>	20m		
<b>Spread</b>	16m		
<b>Significance*</b>	R		
<b>Age (years)</b>	30-60		
<b>Condition*</b>	G		
<b>Notes</b>	Location- Rear, SW corner  This tree is a good quality specimen.		

\* Significance: N-National, S-State, R-Regional, L- Local  
 \* Condition: E- Excellent, G-Good, F-Fair, P-Poor, D-Dead

**Criteria for Significance (please refer page x):**

Historical significance		Rare/Localised distribution		Horticultural/Genetic Value		Particularly old
Curious growth form		Outstanding size		Outstanding Example of the Species		Unique environmental contribution
Unique Location/Context	✓	Aesthetic Value		Aboriginal Culture		

**Statement of Significance:**

The age and size of this tree provides an important contribution o the immediate landscape.

**Map:**

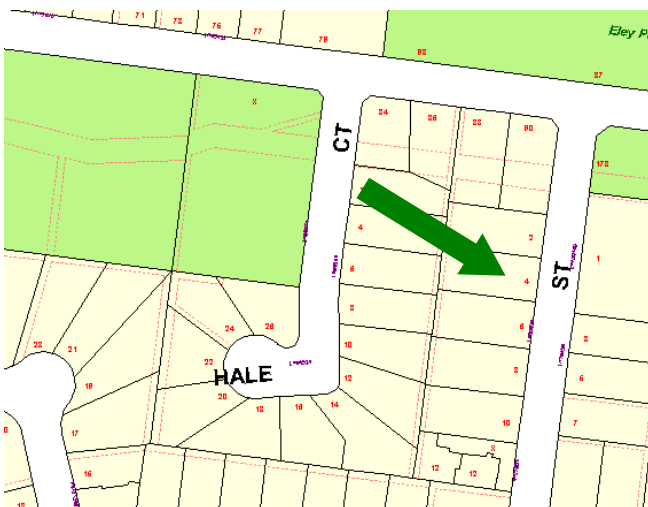

**Photo(s):**



**CITY OF WHITEHORSE- STATEMENT OF TREE SIGNIFICANCE**

Property Address: 22 Sartori Street, Burwood East

Melways Ref: 61 J6

Survey Dates: March/April 2006

Tree No.	1	2	3
Tree Name	<i>Corymbia citriodora</i> Lemon-scented Gum		
DBH	60cm		
Height	16m		
Spread	12m		
Significance*	L		
Age (years)	Mature		
Condition*	G		
Assets within 4 metres	1.5m to driveway		
SULE	20-50		
Notes	Resident was concerned about proximity to the driveway. With care, the driveway could be renewed without damaging the tree. The tree required pruning for hazard reduction to reduce the risk of limb-shed.		

\* Significance: N-National, S-State, R-Regional, L- Local

\* Condition: E- Excellent, G-Good, F-Fair, P-Poor, D-Dead

**Criteria for Significance:**

Historical significance	Rare/Localised distribution	Horticultural/Genetic Value	Particularly old
Curious growth form	Outstanding size	Outstanding Example of the Species	Unique environmental contribution
Unique Location/Context	* Aesthetic Value	Aboriginal Culture	Good example of indigenous species

**Statement of Significance:**

The tree is a good example of the species (which is widely planted throughout Whitehorse and forms part of the landscape character). It contributes to the streetscape and local landscape character.

**Site Map:**



**Photo(s):**



**CITY OF WHITEHORSE- STATEMENT OF TREE SIGNIFICANCE**

**Property Address:** 26 Sevenoaks Rd Burwood East  
**Melways Ref:** 62-A8  
**Survey Dates:** 13.1.02 / March – April 2004

Tree No.	1	2	3
<b>Tree Name</b>	Eucalyptus cephalocarpa Silver Leaf Stringybark		
<b>Tree Size</b>	Mature		
<b>Height</b>	18m		
<b>Spread</b>	12m		
<b>Significance*</b>	R		
<b>Age (years)</b>	60-100		
<b>Condition*</b>	G		
<b>Notes</b>	Location- Frontage (east)  This tree is a good quality specimen		

\* Significance: N-National, S-State, R-Regional, L- Local  
 \* Condition: E- Excellent, G-Good, F-Fair, P-Poor, D-Dead

**Criteria for Significance (please refer page x):**

Historical significance	Rare/Localised distribution	Horticultural/Genetic Value	Particularly old
Curious growth form	Outstanding size	Outstanding Example of the Species	✓ Unique environmental contribution
Unique Location/Context	Aesthetic Value	Aboriginal Culture	

**Statement of Significance:**

This is an indigenous habitat tree of local provenance, that is part of regional vegetation linkages. It provides a vegetation corridor for local bird-life and fauna. It acts as a vegetation source upon which re-vegetation and regeneration of indigenous flora can occur. This tree is integral to the establishment of a sustainable urban and native landscape.

**Map:**

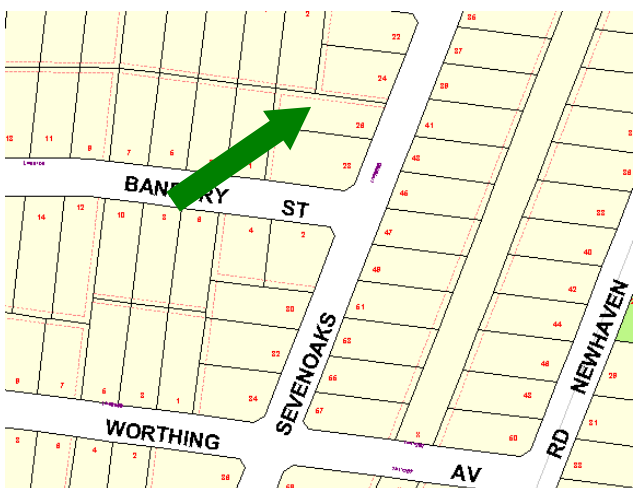

**Photo(s):**



**CITY OF WHITEHORSE- STATEMENT OF TREE SIGNIFICANCE**

**Property Address:** 12 Tarwarri Pl Burwood East

Melways Ref: 61-H7

Survey Dates: 11.5.02 / March – April 2004

Tree No.	1	2	3
<b>Tree Name</b>	Eucalyptus viminalis Manna Gum		
<b>Tree Size</b>	Mature		
<b>Height</b>	24m		
<b>Spread</b>	18m		
<b>Significance*</b>	L		
<b>Age (years)</b>	30-60		
<b>Condition*</b>	G		
<b>Notes</b>	Location- Frontage (north)  This tree is a good quality specimen		

\* Significance: N-National, S-State, R-Regional, L- Local

\* Condition: E- Excellent, G-Good, F-Fair, P-Poor, D-Dead

**Criteria for Significance (please refer page x):**

Historical significance		Rare/Localised distribution		Horticultural/Genetic Value		Particularly old
Curious growth form		Outstanding size		Outstanding Example of the Species		Unique environmental contribution
Unique Location/Context	✓	Aesthetic Value		Aboriginal Culture		

**Statement of Significance:**

The age and size of this tree provides an important contribution to the immediate landscape.

**Map:**

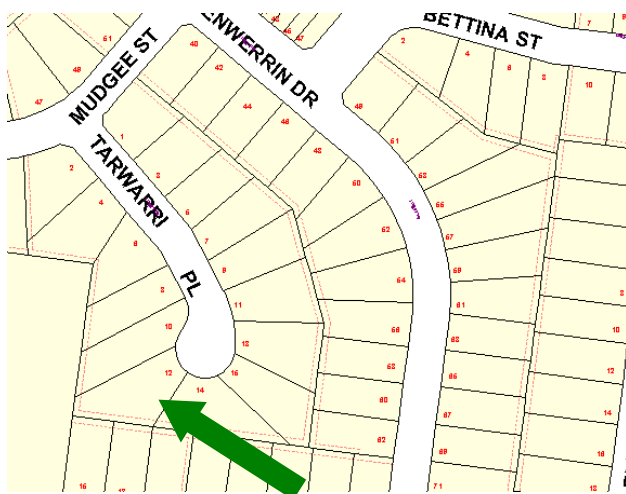

**Photo(s):**





**CITY OF WHITEHORSE- STATEMENT OF TREE SIGNIFICANCE**

**Property Address:** 44 Witchwood Cres Burwood East

Melways Ref: 61-J7

Survey Dates: 22.5.02 / March – April 2004

Tree No.	1	2	3
<b>Tree Name</b>	Eucalyptus maculata Spotted Gum		
<b>Tree Size</b>	Mature		
<b>Height</b>	18m		
<b>Spread</b>	10m		
<b>Significance*</b>	L		
<b>Age (years)</b>	60-100		
<b>Condition*</b>	G		
<b>Notes</b>	Location- SE frontage  This tree is a good quality specimen		

\* Significance: N-National, S-State, R-Regional, L- Local

\* Condition: E- Excellent, G-Good, F-Fair, P-Poor, D-Dead

**Criteria for Significance (please refer page x):**

Historical significance		Rare/Localised distribution		Horticultural/Genetic Value		Particularly old
Curious growth form		Outstanding size		Outstanding Example of the Species		Unique environmental contribution
Unique Location/Context	✓	Aesthetic Value		Aboriginal Culture		

**Statement of Significance:**

The age and size of this tree provides an important contribution to the immediate landscape.

**Map:**

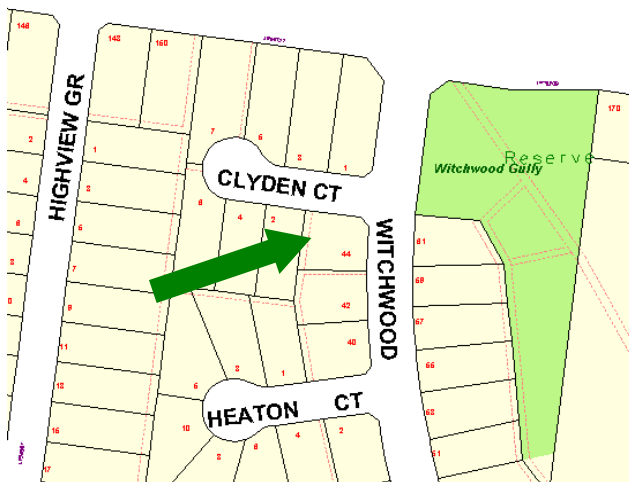

**Photo(s):**



**CITY OF WHITEHORSE- STATEMENT OF TREE SIGNIFICANCE**

**Property Address:** 28 Worthing Ave Burwood East  
**Melways Ref:** 62-A8  
**Survey Dates:** 11.4.02 / March – April 2004

Tree No.	1	2	3
<b>Tree Name</b>	Eucalyptus cephalocarpa Silver Leaf Stringybark	Eucalyptus cephalocarpa Silver Leaf Stringybark	Eucalyptus cephalocarpa Silver Leaf Stringybark
<b>Tree Size</b>	Mature	Mature	Mature
<b>Height</b>	18m	15m	15m
<b>Spread</b>	15m	14m	18m
<b>Significance*</b>	L	L	L
<b>Age (years)</b>	30-60	30-60	30-60
<b>Condition*</b>	G	G	G
<b>Notes</b>	Location- Frontage. Three leaders  This tree is a good quality specimen	Location- Rear East Carport This tree is a good quality specimen	Location- Rear- SE corner This tree is a good quality specimen

\* Significance: N-National, S-State, R-Regional, L- Local  
 \* Condition: E- Excellent, G-Good, F-Fair, P-Poor, D-Dead

**Criteria for Significance (please refer page x):**

Historical significance	Rare/Localised distribution	Horticultural/Genetic Value	Particularly old
Curious growth form	Outstanding size	Outstanding Example of the Species	✓ Unique environmental contribution
Unique Location/Context	Aesthetic Value	Aboriginal Culture	

**Statement of Significance:**

These are indigenous habitat trees of local provenance, that are part of regional vegetation linkages. They provide a vegetation corridor for local bird-life and fauna. They act as a vegetation source upon which re-vegetation and regeneration of indigenous flora can occur. These trees are integral to the establishment of a sustainable urban and native landscape.

**Map:**

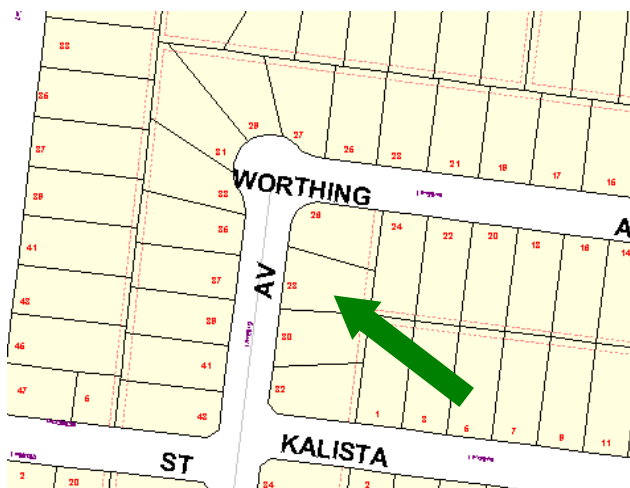

**Photo(s):**



**Tree 1**

**CITY OF WHITEHORSE- STATEMENT OF TREE SIGNIFICANCE**

**Property Address:** 30 Worthing Ave Burwood East  
**Melways Ref:** 62-A8  
**Survey Dates:** 22.1.02 / March – April 2004

Tree No.	1	2	3
<b>Tree Name</b>	Eucalyptus muelleriana Yellow Stringybark	Eucalyptus muelleriana Yellow Stringybark	
<b>Tree Size</b>	Mature	Mature	
<b>Height</b>	18m	16m	
<b>Spread</b>	10m	10m	
<b>Significance*</b>	L	L	
<b>Age (years)</b>	30-60	30-60	
<b>Condition*</b>	G	G	
<b>Notes</b>	Location- north side  This tree is a good quality specimen	Location- Frontage SW  This tree is a good quality specimen	

\* Significance: N-National, S-State, R-Regional, L- Local  
 \* Condition: E- Excellent, G-Good, F-Fair, P-Poor, D-Dead

**Criteria for Significance (please refer page x):**

Historical significance		Rare/Localised distribution		Horticultural/Genetic Value		Particularly old
Curious growth form		Outstanding size		Outstanding Example of the Species		Unique environmental contribution
Unique Location/Context	✓	Aesthetic Value		Aboriginal Culture		

**Statement of Significance:**

The age and size of this tree provides an important contribution to the immediate landscape.

**Map:**

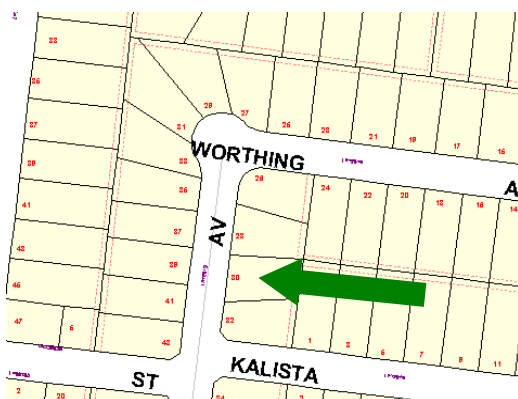

**Photo(s):**



**Tree 1**

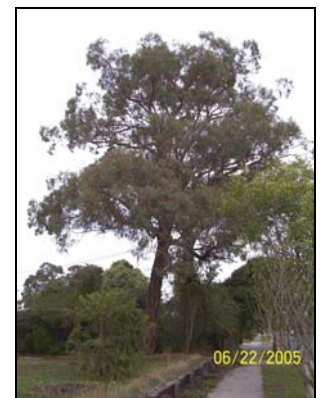

**Tree 2**

**CITY OF WHITEHORSE- STATEMENT OF TREE SIGNIFICANCE**

**Property Address:** 31 Worthing Ave Burwood East  
 Melways Ref: 62-A8  
 Survey Dates: 22.1.02 / March – April 2004

Tree No.	1	2	3
<b>Tree Name</b>			Eucalyptus cephalocarpa Silver Leaf Stringybark
<b>Tree Size</b>			Mature
<b>Height</b>			18m
<b>Spread</b>			10m
<b>Significance*</b>			R
<b>Age (years)</b>			30-60
<b>Condition*</b>			G
<b>Notes</b>			Location- Rear, east side This tree is a good quality specimen

\* Significance: N-National, S-State, R-Regional, L- Local  
 \* Condition: E- Excellent, G-Good, F-Fair, P-Poor, D-Dead

**Criteria for Significance (please refer page x):**

Historical significance		Rare/Localised distribution		Horticultural/Genetic Value		Particularly old
Curious growth form		Outstanding size		Outstanding Example of the Species		Unique environmental contribution
Unique Location/Context	✓	Aesthetic Value		Aboriginal Culture		

**Statement of Significance:**

The age and size of this tree provides an important contribution to the immediate landscape.

**Map:**



**Photo(s):**



**Tree 3**

**CITY OF WHITEHORSE- STATEMENT OF TREE SIGNIFICANCE**

**Property Address:** 47 Worthing Ave Burwood East

Melways Ref: 62-A8

Survey Dates: 25.4.02 / March – April 2004

Tree No.	1	2	3
Tree Name	Eucalyptus sideroxylon Mugga Ironbark		
Tree Size	Mature		
Height	22m		
Spread	10m		
Significance*	L		
Age (years)	30-60		
Condition*	G		
Notes	Location- Frontage. Cut east side for electricity lines		

\* Significance: N-National, S-State, R-Regional, L- Local

\* Condition: E- Excellent, G-Good, F-Fair, P-Poor, D-Dead

**Criteria for Significance (please refer page x):**

	Historical significance	Rare/Localised distribution	Horticultural/Genetic Value	Particularly old
	Curious growth form	Outstanding size	Outstanding Example of the Species	Unique environmental contribution
✓	Unique Location/Context	Aesthetic Value	Aboriginal Culture	

**Statement of Significance:**

This is an indigenous habitat tree of local provenance, that is part of regional vegetation linkages. It provides a vegetation corridor for local bird-life and fauna. It acts as a vegetation source upon which re-vegetation and regeneration of indigenous flora can occur. This tree is integral to the establishment of a sustainable urban and native landscape.

**Map:**

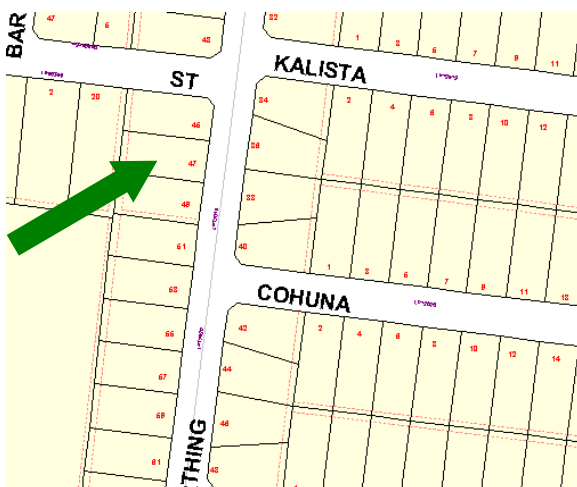

**Photo(s):**



**CITY OF WHITEHORSE- STATEMENT OF TREE SIGNIFICANCE**

**Property Address:** 49 Worthing Ave Burwood East  
**Melways Ref:** 62-A8  
**Survey Dates:** 22.1.02 / March – April 2004

Tree No.	1	2	3
<b>Tree Name</b>	Eucalyptus cephalocarpa Silver Leaf Stringybark		
<b>Tree Size</b>	Mature		
<b>Height</b>	18m		
<b>Spread</b>	13m		
<b>Significance*</b>	L		
<b>Age (years)</b>	60-100		
<b>Condition*</b>	G		
<b>Notes</b>	Location- Frontage, central  This tree is a good quality specimen		

\* Significance: N-National, S-State, R-Regional, L- Local  
 \* Condition: E- Excellent, G-Good, F-Fair, P-Poor, D-Dead

**Criteria for Significance (please refer page x):**

Historical significance	Rare/Localised distribution	Horticultural/Genetic Value	Particularly old
Curious growth form	Outstanding size	Outstanding Example of the Species	✓ Unique environmental contribution
Unique Location/Context	Aesthetic Value	Aboriginal Culture	

**Statement of Significance:**

This is an indigenous habitat tree of local provenance, that is part of regional vegetation linkages. It provides a vegetation corridor for local bird-life and fauna. It acts as a vegetation source upon which re-vegetation and regeneration of indigenous flora can occur. This tree is integral to the establishment of a sustainable urban and native landscape.

**Map:**

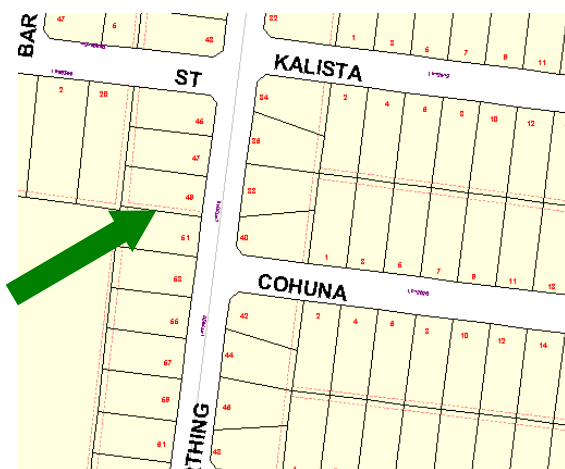

**Photo(s):**

